

Intercept® ULTRA Simulation Model

For More Information,
Contact Your
GED Sales Manager

GED Integrated Solutions
9280 Dutton Drive
Twinsburg, OH
44087-1967

Telephone: 330.963.5401
Fax: 330.963.0584
www.gedusa.com

For THERM

- ✓ Spacer wall thickness: ULTRA material = 0.0077"
Blackline material = 0.0077"
- ✓ Thermal conductivity: ULTRA material = 13.63 W/m°K
Blackline material = 13.63 W/m°K
Desiccant = 0.29 W/m°K
Sealant = 0.24 W/m°K
- ✓ Spacer should be below sight line
- ✓ All dimensions in inches

Accurate Geometry

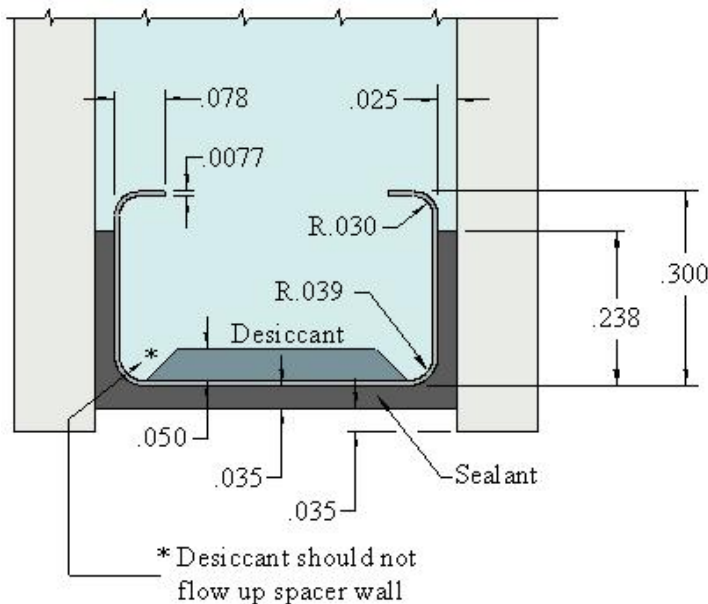

Inaccurate Geometry

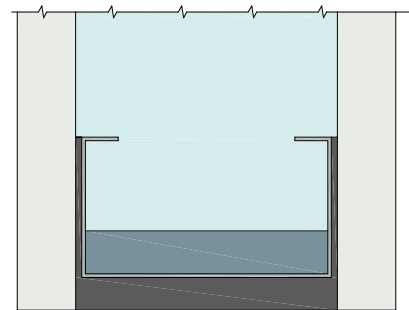

Intercept® Tinplate Simulation Model

**For More Information,
Contact Your
GED Sales Manager**

GED Integrated Solutions
9280 Dutton Drive
Twinsburg, OH
44087-1967

Telephone:
330.963.5401
Fax: 330.963.0584
www.gedusa.com

For THERM

- ✓ Spacer wall thickness: Tinplate material = 0.010"
Blackline material = 0.010"
- ✓ Thermal conductivity: Tinplate material = 62 W/m^oK
Blackline material = 50 W/m^oK
Desiccant = 0.29 W/m^oK
Sealant = 0.24 W/m^oK
- ✓ Spacer should be below sight line
- ✓ All dimensions in inches

Accurate Geometry

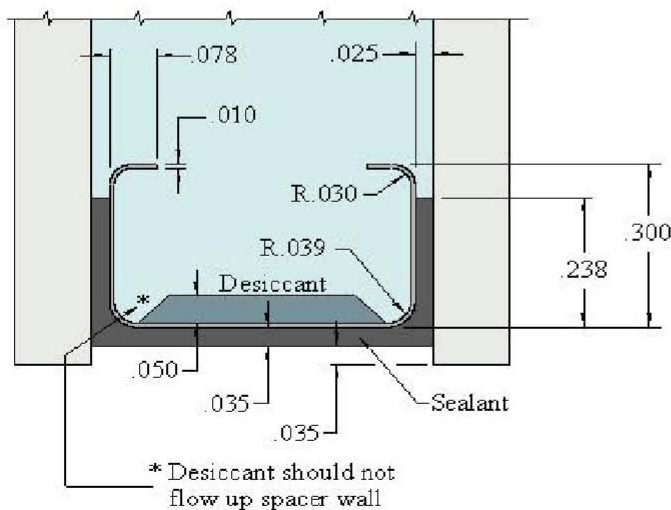

Inaccurate Geometry

